

**MUNICIPALITY OF
DUTTON-DUNWICH
INDEX MAP**

By-law No. 2022-50

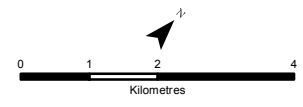

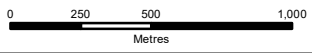
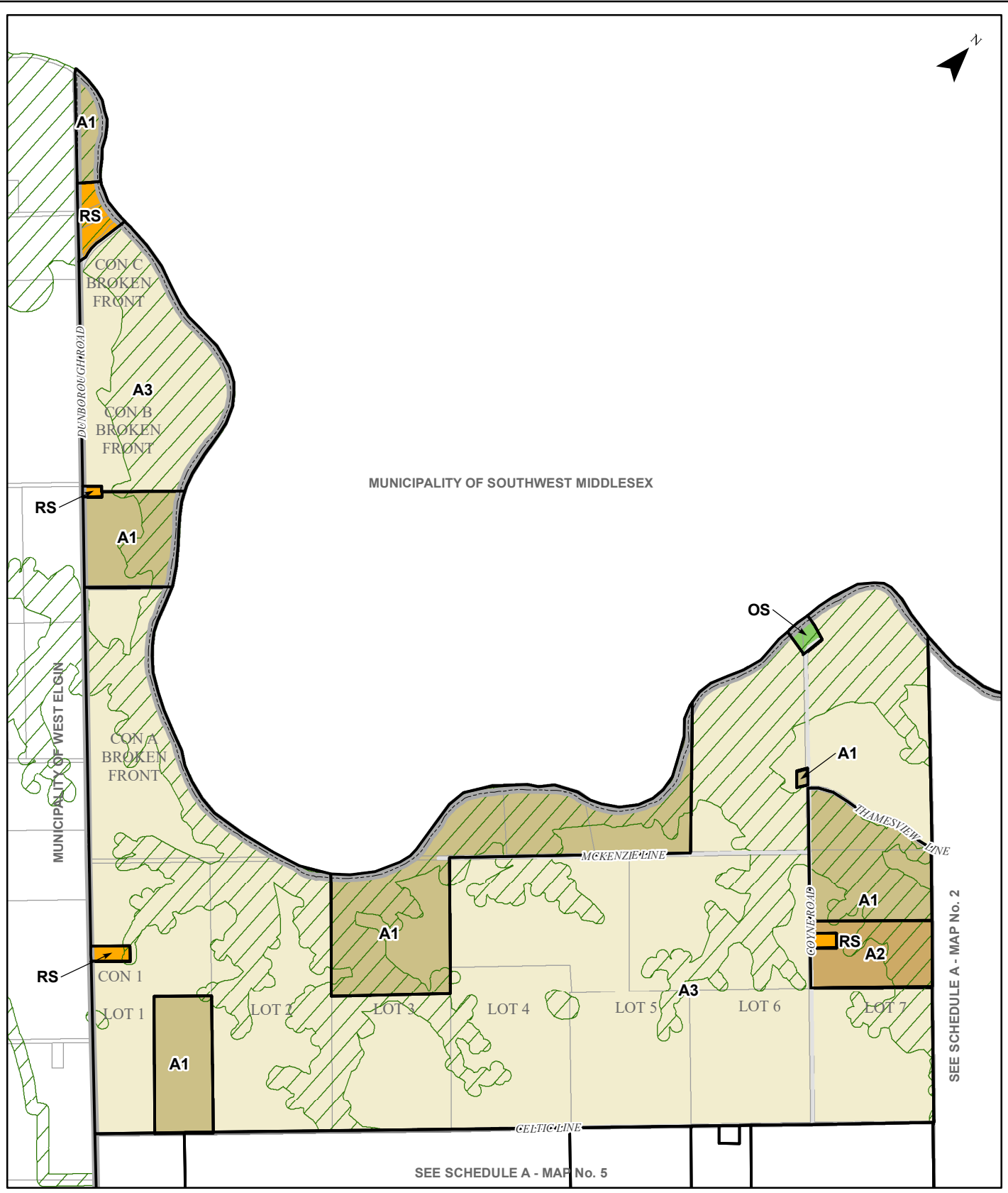

LEGEND

AGRICULTURE (A1)	LIMITED SERVICE RESIDENTIAL (LSR)	INSTITUTIONAL (I)
SPECIAL AGRICULTURE (A2)	LAKESHORE RECREATION (LR)	PUBLIC UTILITY (U)
LARGE LOT AGRICULTURE (A3)	FARM INDUSTRIAL/COMMERCIAL (M1)	HAMLET COMMERCIAL (HC)
VILLAGE RESIDENTIAL ZONE 1 (VR1)	RURAL INDUSTRIAL (M2)	HIGHWAY COMMERCIAL (C1)
VILLAGE RESIDENTIAL ZONE 2 (VR2)	EXTRACTIVE INDUSTRIAL (M3)	VILLAGE GENERAL COMMERCIAL (VC1)
HAMLET RESIDENTIAL (HR)	VILLAGE INDUSTRIAL (M4)	VILLAGE LOCAL COMMERCIAL (VC2)
RURAL RESIDENTIAL (RR)	ENVIRONMENTAL PROTECTION (EP)	LTVCA REGULATION LIMIT
SPECIAL RURAL RESIDENTIAL (RS)	OPEN SPACE (OS)	PROVINCIAALLY SIGNIFICANT WETLAND
	PARKLAND (P)	

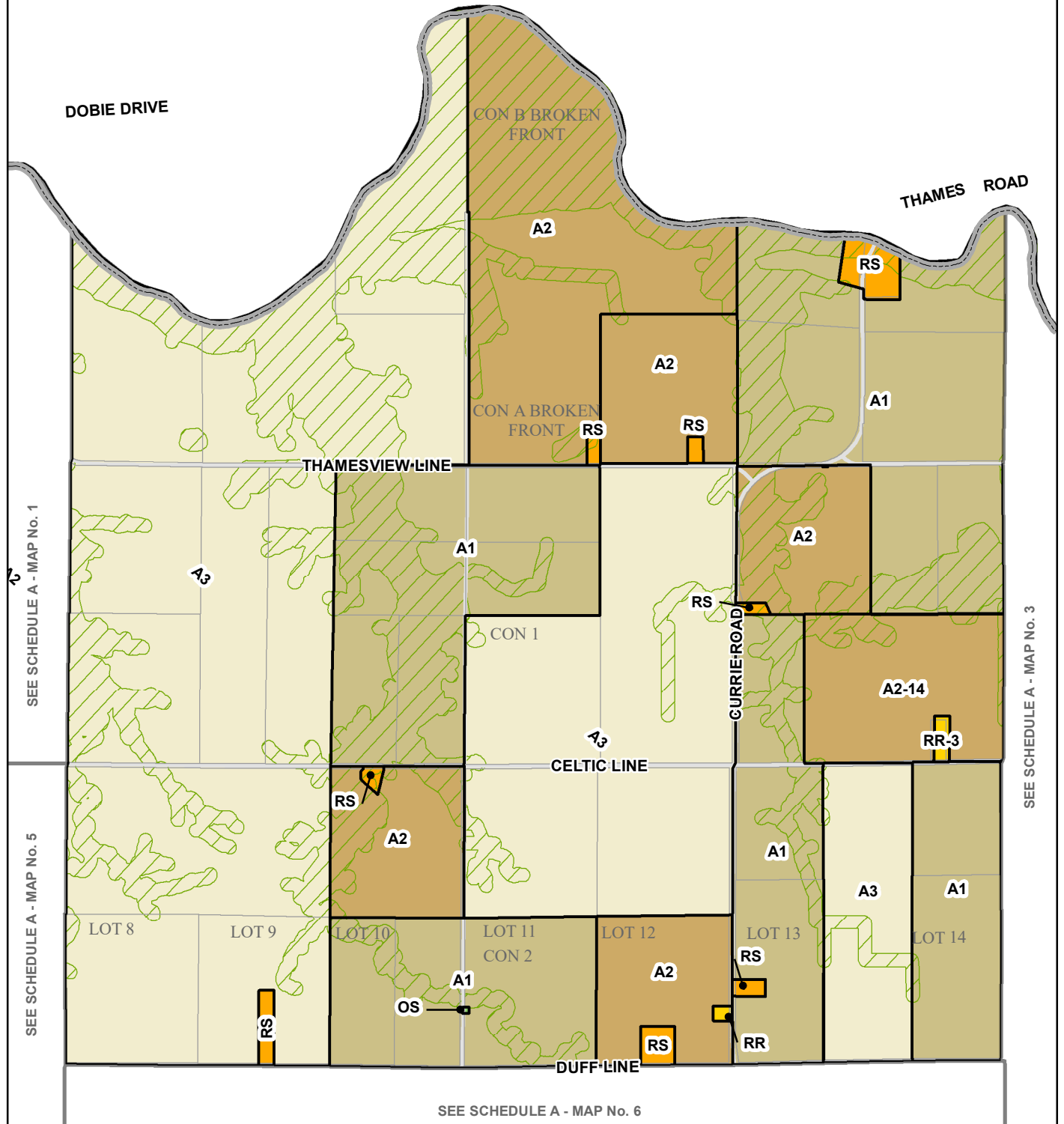

**MUNICIPALITY OF
DUTTON-DUNWICH
SCHEDULE A
MAP No. 2**

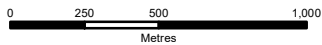

LEGEND

- | | | |
|----------------------------------|-----------------------------------|----------------------------------|
| AGRICULTURE (A1) | LIMITED SERVICE RESIDENTIAL (LSR) | INSTITUTIONAL (I) |
| SPECIAL AGRICULTURE (A2) | LAKESHORE RECREATION (LR) | PUBLIC UTILITY (U) |
| LARGE LOT AGRICULTURE (A3) | FARM INDUSTRIAL/COMMERCIAL (M1) | HAMLET COMMERCIAL (HC) |
| VILLAGE RESIDENTIAL ZONE 1 (VR1) | RURAL INDUSTRIAL (M2) | HIGHWAY COMMERCIAL (C1) |
| VILLAGE RESIDENTIAL ZONE 2 (VR2) | EXTRACTIVE INDUSTRIAL (M3) | VILLAGE GENERAL COMMERCIAL (VC1) |
| HAMLET RESIDENTIAL (HR) | VILLAGE INDUSTRIAL (M4) | VILLAGE LOCAL COMMERCIAL (VC2) |
| RURAL RESIDENTIAL (RR) | ENVIRONMENTAL PROTECTION (EP) | LTVCA REGULATION LIMIT |
| SPECIAL RURAL RESIDENTIAL (RS) | OPEN SPACE (OS) | PROVINCIALLY SIGNIFICANT WETLAND |
| | PARKLAND (P) | |



MUNICIPALITY OF SOUTHWEST MIDDLESEX

CON A
BROKEN FRONT

THAMESVIEW LINE

HIGHLAND ROAD

CELTIC LINE

DUFF LINE

WILHELM ROAD

CHALMERS LINE

SEE SCHEDULE A - MAP No. 2

SEE SCHEDULE A - MAP No. 6

SEE SCHEDULE A - MAP No. 4

SEE SCHEDULE A - MAP No. 7

MUNICIPALITY OF DUTTON-DUNWICH SCHEDULE A MAP No. 3

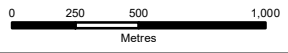

LEGEND

- AGRICULTURE (A1)
- SPECIAL AGRICULTURE (A2)
- LARGE LOT AGRICULTURE (A3)
- VILLAGE RESIDENTIAL ZONE 1 (VR1)
- VILLAGE RESIDENTIAL ZONE 2 (VR2)
- HAMLET RESIDENTIAL (HR)
- RURAL RESIDENTIAL (RR)
- SPECIAL RURAL RESIDENTIAL (RS)
- LIMITED SERVICE RESIDENTIAL (LSR)
- LAKESHORE RECREATION (LR)
- FARM INDUSTRIAL/COMMERCIAL (M1)
- RURAL INDUSTRIAL (M2)
- EXTRACTIVE INDUSTRIAL (M3)
- VILLAGE INDUSTRIAL (M4)
- ENVIRONMENTAL PROTECTION (EP)
- OPEN SPACE (OS)
- PARKLAND (P)
- INSTITUTIONAL (I)
- PUBLIC UTILITY (U)
- HAMLET COMMERCIAL (HC)
- HIGHWAY COMMERCIAL (C1)
- VILLAGE GENERAL COMMERCIAL (VC1)
- VILLAGE LOCAL COMMERCIAL (VC2)
- LTVCA REGULATION LIMIT
- PROVINCIALLY SIGNIFICANT WETLAND

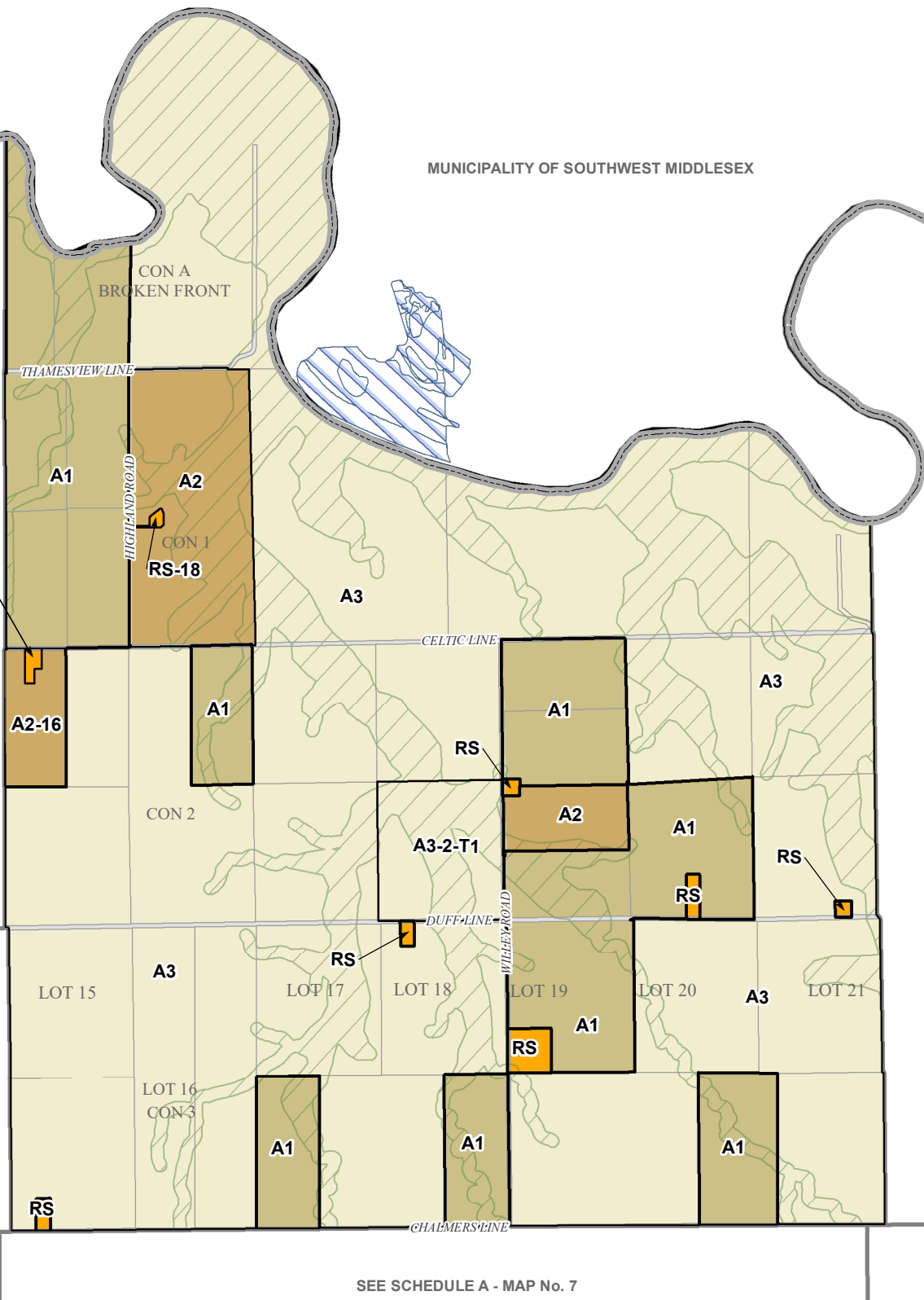

MUNICIPALITY OF SOUTHWEST MIDDLESEX

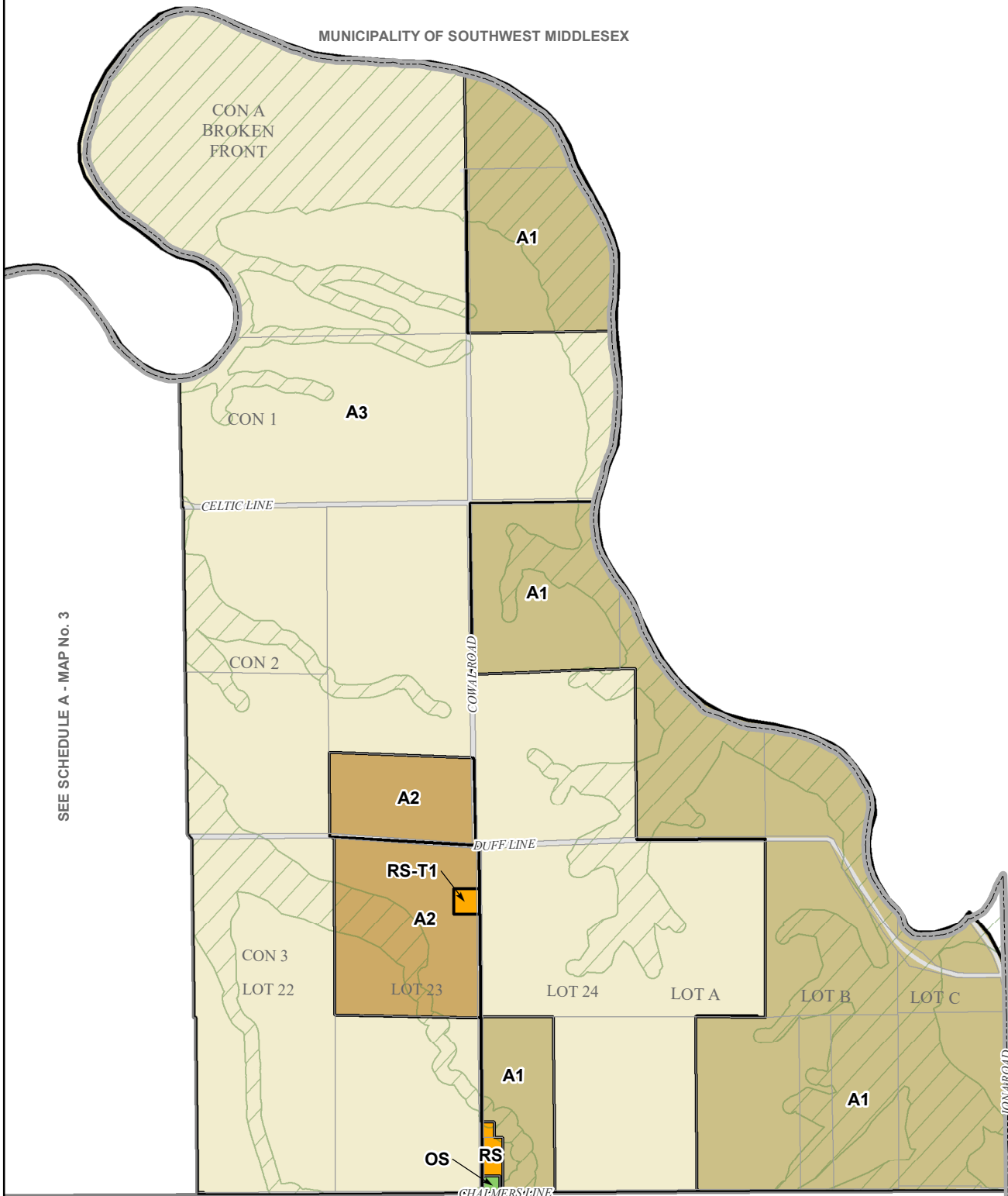

SEE SCHEDULE A - MAP No. 3

MUNICIPALITY OF SOUTHWOLD

SEE SCHEDULE A - MAP No. 7

SEE SCHEDULE A - MAP No. 8

MUNICIPALITY OF DUTTON-DUNWICH
SCHEDULE A
MAP No. 4

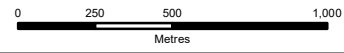

LEGEND					
	AGRICULTURE (A1)		LIMITED SERVICE RESIDENTIAL (LSR)		INSTITUTIONAL (I)
	SPECIAL AGRICULTURE (A2)		LAKESHORE RECREATION (LR)		PUBLIC UTILITY (U)
	LARGE LOT AGRICULTURE (A3)		FARM INDUSTRIAL/COMMERCIAL (M1)		HAMLET COMMERCIAL (HC)
	VILLAGE RESIDENTIAL ZONE 1 (VR1)		RURAL INDUSTRIAL (M2)		HIGHWAY COMMERCIAL (C1)
	VILLAGE RESIDENTIAL ZONE 2 (VR2)		EXTRACTIVE INDUSTRIAL (M3)		VILLAGE GENERAL COMMERCIAL (VC1)
	HAMLET RESIDENTIAL (HR)		VILLAGE INDUSTRIAL (M4)		VILLAGE LOCAL COMMERCIAL (VC2)
	RURAL RESIDENTIAL (RR)		ENVIRONMENTAL PROTECTION (EP)		LTVCA REGULATION LIMIT
	SPECIAL RURAL RESIDENTIAL (RS)		OPEN SPACE (OS)		PROVINCIALY SIGNIFICANT WETLAND
	PARKLAND (P)				

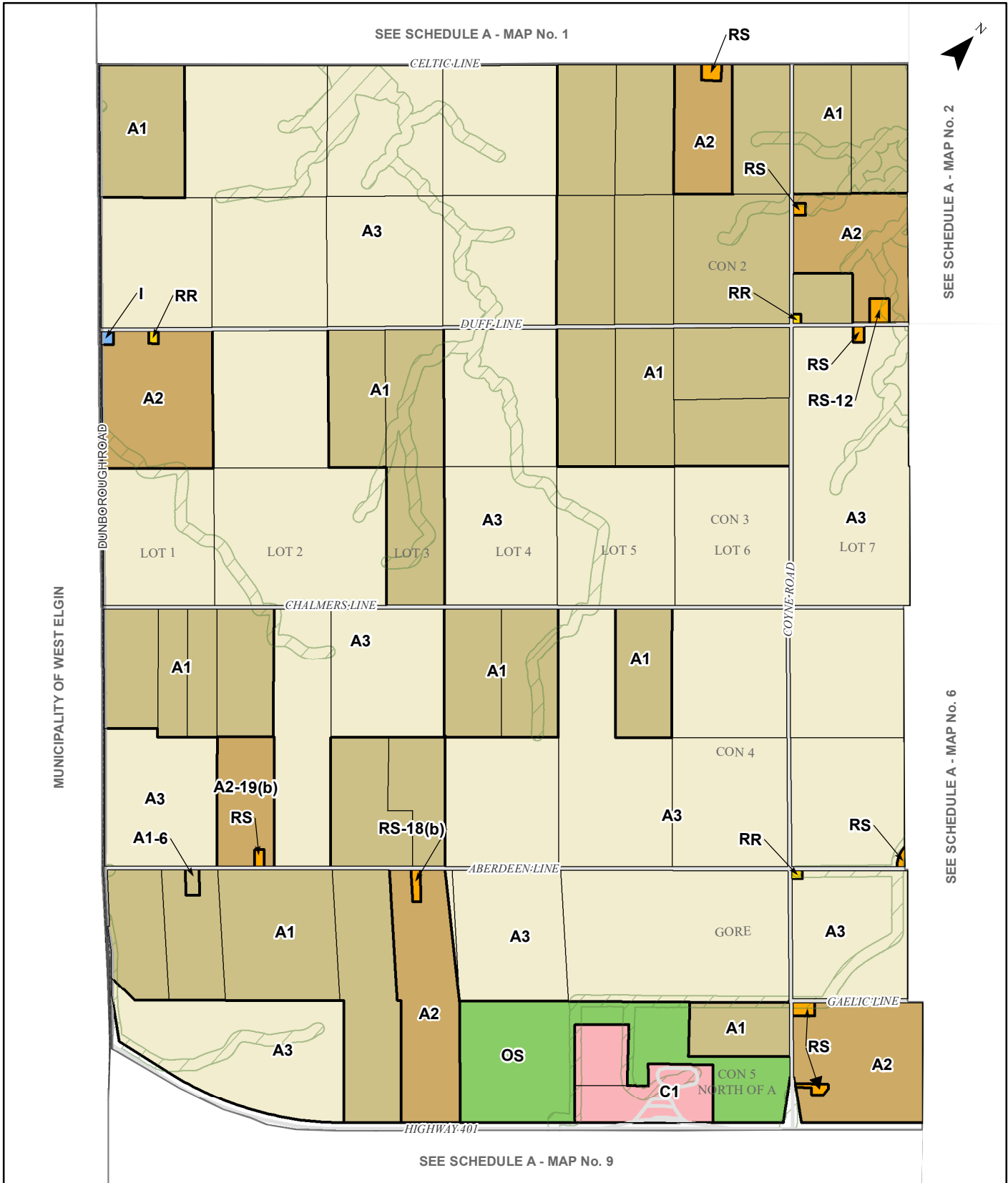

**MUNICIPALITY OF
DUTTON-DUNWICH
SCHEDULE A
MAP No. 5**

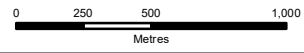

LEGEND

- | | | |
|---|---|--|
| <ul style="list-style-type: none"> ■ AGRICULTURE (A1) ■ SPECIAL AGRICULTURE (A2) ■ LARGE LOT AGRICULTURE (A3) ■ VILLAGE RESIDENTIAL ZONE 1 (VR1) ■ VILLAGE RESIDENTIAL ZONE 2 (VR2) ■ HAMLET RESIDENTIAL (HR) ■ RURAL RESIDENTIAL (RR) ■ SPECIAL RURAL RESIDENTIAL (RS) | <ul style="list-style-type: none"> ■ LIMITED SERVICE RESIDENTIAL (LSR) ■ LAKESHORE RECREATION (LR) ■ FARM INDUSTRIAL/COMMERCIAL (M1) ■ RURAL INDUSTRIAL (M2) ■ EXTRACTIVE INDUSTRIAL (M3) ■ VILLAGE INDUSTRIAL (M4) ■ ENVIRONMENTAL PROTECTION (EP) ■ OPEN SPACE (OS) ■ PARKLAND (P) | <ul style="list-style-type: none"> ■ INSTITUTIONAL (I) ■ PUBLIC UTILITY (U) ■ HAMLET COMMERCIAL (HC) ■ HIGHWAY COMMERCIAL (C1) ■ VILLAGE GENERAL COMMERCIAL (VC1) ■ VILLAGE LOCAL COMMERCIAL (VC2) ■ LTVCA REGULATION LIMIT ■ PROVINCIALLY SIGNIFICANT WETLAND |
|---|---|--|

SEE SCHEDULE A - MAP No. 2

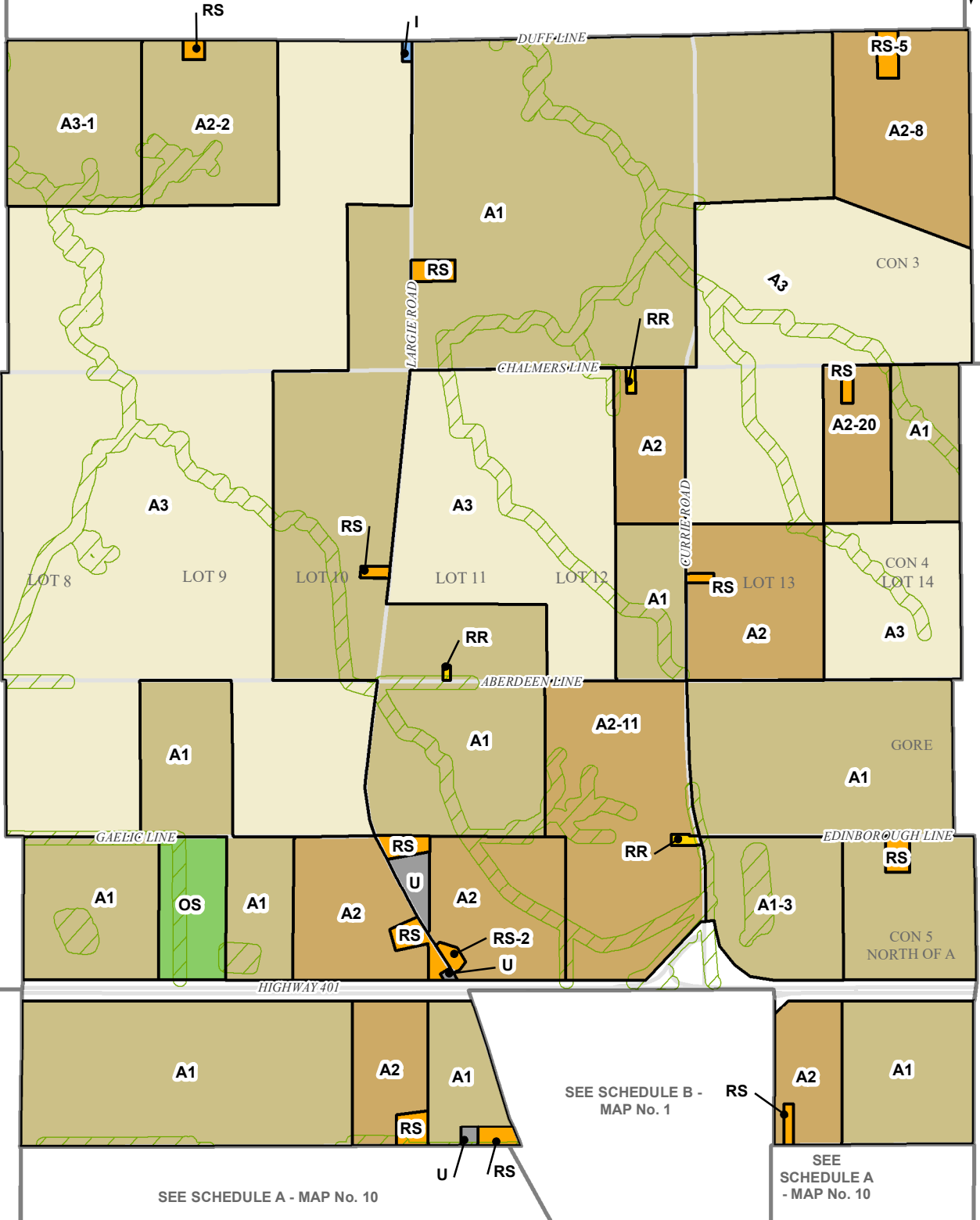

**MUNICIPALITY OF
DUTTON-DUNWICH
SCHEDULE A
MAP No. 6**



LEGEND

- | | | |
|----------------------------------|-----------------------------------|----------------------------------|
| AGRICULTURE (A1) | LIMITED SERVICE RESIDENTIAL (LSR) | INSTITUTIONAL (I) |
| SPECIAL AGRICULTURE (A2) | LAKESHORE RECREATION (LR) | PUBLIC UTILITY (U) |
| LARGE LOT AGRICULTURE (A3) | FARM INDUSTRIAL/COMMERCIAL (M1) | HAMLET COMMERCIAL (HC) |
| VILLAGE RESIDENTIAL ZONE 1 (VR1) | RURAL INDUSTRIAL (M2) | HIGHWAY COMMERCIAL (C1) |
| VILLAGE RESIDENTIAL ZONE 2 (VR2) | EXTRACTIVE INDUSTRIAL (M3) | VILLAGE GENERAL COMMERCIAL (VC1) |
| HAMLET RESIDENTIAL (HR) | VILLAGE INDUSTRIAL (M4) | VILLAGE LOCAL COMMERCIAL (VC2) |
| RURAL RESIDENTIAL (RR) | ENVIRONMENTAL PROTECTION (EP) | OPEN SPACE (OS) |
| SPECIAL RURAL RESIDENTIAL (RS) | OPEN SPACE (OS) | PARKLAND (P) |
| | PARKLAND (P) | LTVCA REGULATION LIMIT |
| | | PROVINCIALLY SIGNIFICANT WETLAND |



SEE SCHEDULE A - MAP No. 3

CHALMERS LINE

SEE SCHEDULE A - MAP No. 6

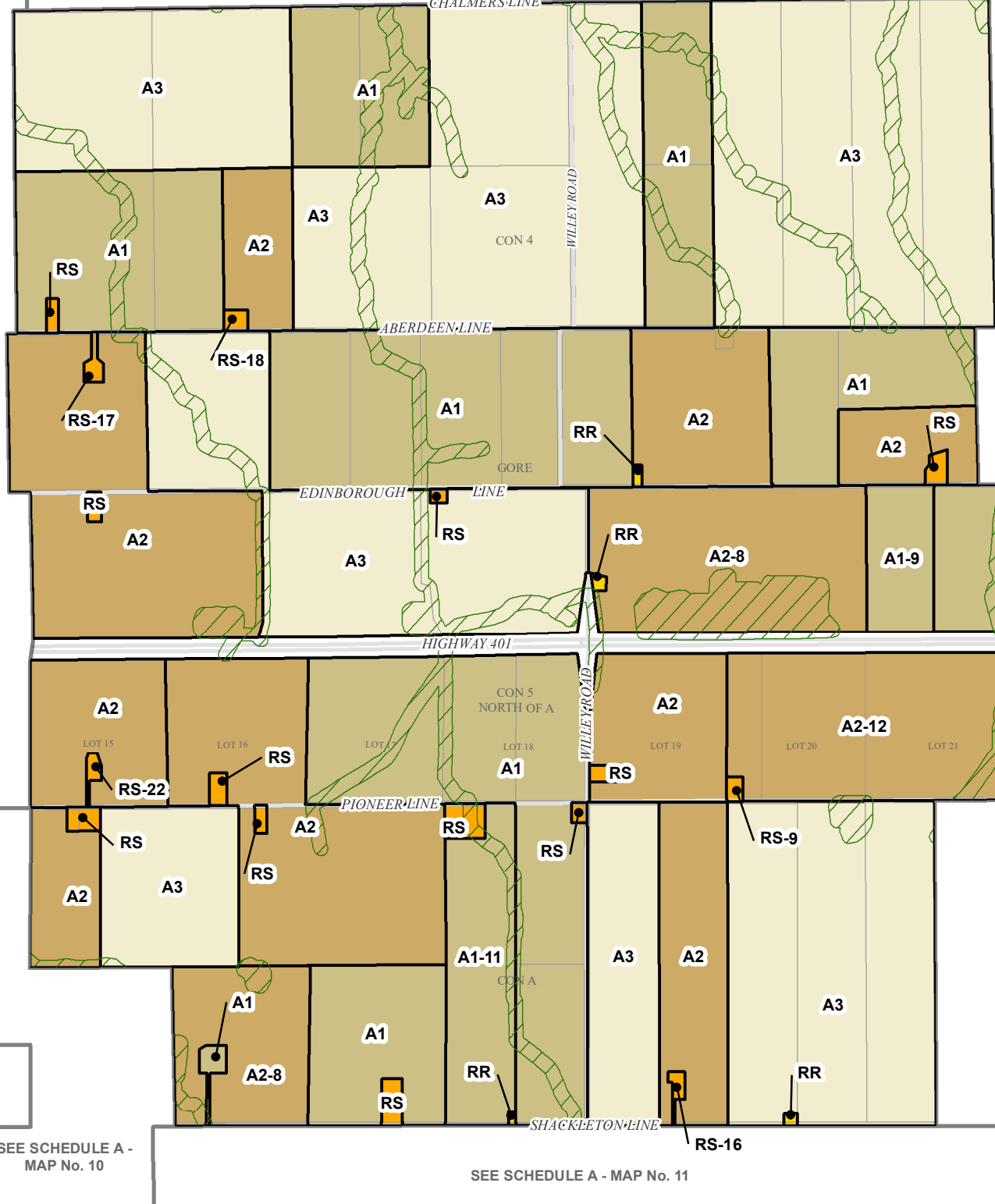

SEE SCHEDULE A - MAP No. 8

SEE SCHEDULE A - MAP No. 10

SEE SCHEDULE A - MAP No. 11

**MUNICIPALITY OF
DUTTON-DUNWICH
SCHEDULE A
MAP No. 7**

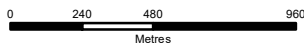

LEGEND

AGRICULTURE (A1)	LIMITED SERVICE RESIDENTIAL (LSR)	INSTITUTIONAL (I)
SPECIAL AGRICULTURE (A2)	LAKESHORE RECREATION (LR)	PUBLIC UTILITY (U)
LARGE LOT AGRICULTURE (A3)	FARM INDUSTRIAL/COMMERCIAL (M1)	HAMLET COMMERCIAL (HC)
VILLAGE RESIDENTIAL ZONE 1 (VR1)	RURAL INDUSTRIAL (M2)	HIGHWAY COMMERCIAL (C1)
VILLAGE RESIDENTIAL ZONE 2 (VR2)	EXTRACTIVE INDUSTRIAL (M3)	VILLAGE GENERAL COMMERCIAL (VC1)
HAMLET RESIDENTIAL (HR)	VILLAGE INDUSTRIAL (M4)	VILLAGE LOCAL COMMERCIAL (VC2)
RURAL RESIDENTIAL (RR)	ENVIRONMENTAL PROTECTION (EP)	LTVCA REGULATION LIMIT
SPECIAL RURAL RESIDENTIAL (RS)	OPEN SPACE (OS)	PROVINCIALLY SIGNIFICANT WETLAND
	PARKLAND (P)	



**MUNICIPALITY OF
DUTTON-DUNWICH
SCHEDULE A
MAP No. 8**

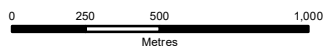

LEGEND

- | | | |
|---|---|---|
| <ul style="list-style-type: none"> ■ AGRICULTURE (A1) ■ SPECIAL AGRICULTURE (A2) ■ LARGE LOT AGRICULTURE (A3) ■ VILLAGE RESIDENTIAL ZONE 1 (VR1) ■ VILLAGE RESIDENTIAL ZONE 2 (VR2) ■ HAMLET RESIDENTIAL (HR) ■ RURAL RESIDENTIAL (RR) ■ SPECIAL RURAL RESIDENTIAL (RS) | <ul style="list-style-type: none"> ■ LIMITED SERVICE RESIDENTIAL (LSR) ■ LAKESHORE RECREATION (LR) ■ FARM INDUSTRIAL/COMMERCIAL (M1) ■ RURAL INDUSTRIAL (M2) ■ EXTRACTIVE INDUSTRIAL (M3) ■ VILLAGE INDUSTRIAL (M4) ■ ENVIRONMENTAL PROTECTION (EP) ■ OPEN SPACE (OS) ■ PARKLAND (P) | <ul style="list-style-type: none"> ■ INSTITUTIONAL (I) ■ PUBLIC UTILITY (U) ■ HAMLET COMMERCIAL (HC) ■ HIGHWAY COMMERCIAL (C1) ■ VILLAGE GENERAL COMMERCIAL (VC1) ■ VILLAGE LOCAL COMMERCIAL (VC2) ■ LTVCA REGULATION LIMIT ■ PROVINCIAALLY SIGNIFICANT WETLAND |
|---|---|---|

SEE SCHEDULE A - MAP No. 5



SEE SCHEDULE A -
MAP No. 6

SEE SCHEDULE A - MAP No. 10

SEE SCHEDULE A - MAP No. 13

MUNICIPALITY OF WEST ELGIN

**MUNICIPALITY OF
DUTTON-DUNWICH
SCHEDULE A
MAP No. 9**

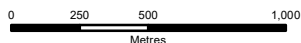

LEGEND

- | | | |
|----------------------------------|-----------------------------------|----------------------------------|
| AGRICULTURE (A1) | LIMITED SERVICE RESIDENTIAL (LSR) | INSTITUTIONAL (I) |
| SPECIAL AGRICULTURE (A2) | LAKESHORE RECREATION (LR) | PUBLIC UTILITY (U) |
| LARGE LOT AGRICULTURE (A3) | FARM INDUSTRIAL/COMMERCIAL (M1) | HAMLET COMMERCIAL (HC) |
| VILLAGE RESIDENTIAL ZONE 1 (VR1) | RURAL INDUSTRIAL (M2) | HIGHWAY COMMERCIAL (C1) |
| VILLAGE RESIDENTIAL ZONE 2 (VR2) | EXTRACTIVE INDUSTRIAL (M3) | VILLAGE GENERAL COMMERCIAL (VC1) |
| HAMLET RESIDENTIAL (HR) | VILLAGE INDUSTRIAL (M4) | VILLAGE LOCAL COMMERCIAL (VC2) |
| RURAL RESIDENTIAL (RR) | ENVIRONMENTAL PROTECTION (EP) | LTVCA REGULATION LIMIT |
| SPECIAL RURAL RESIDENTIAL (RS) | OPEN SPACE (OS) | PROVINCIALLY SIGNIFICANT WETLAND |
| SPECIAL RURAL RESIDENTIAL (RS) | PARKLAND (P) | |

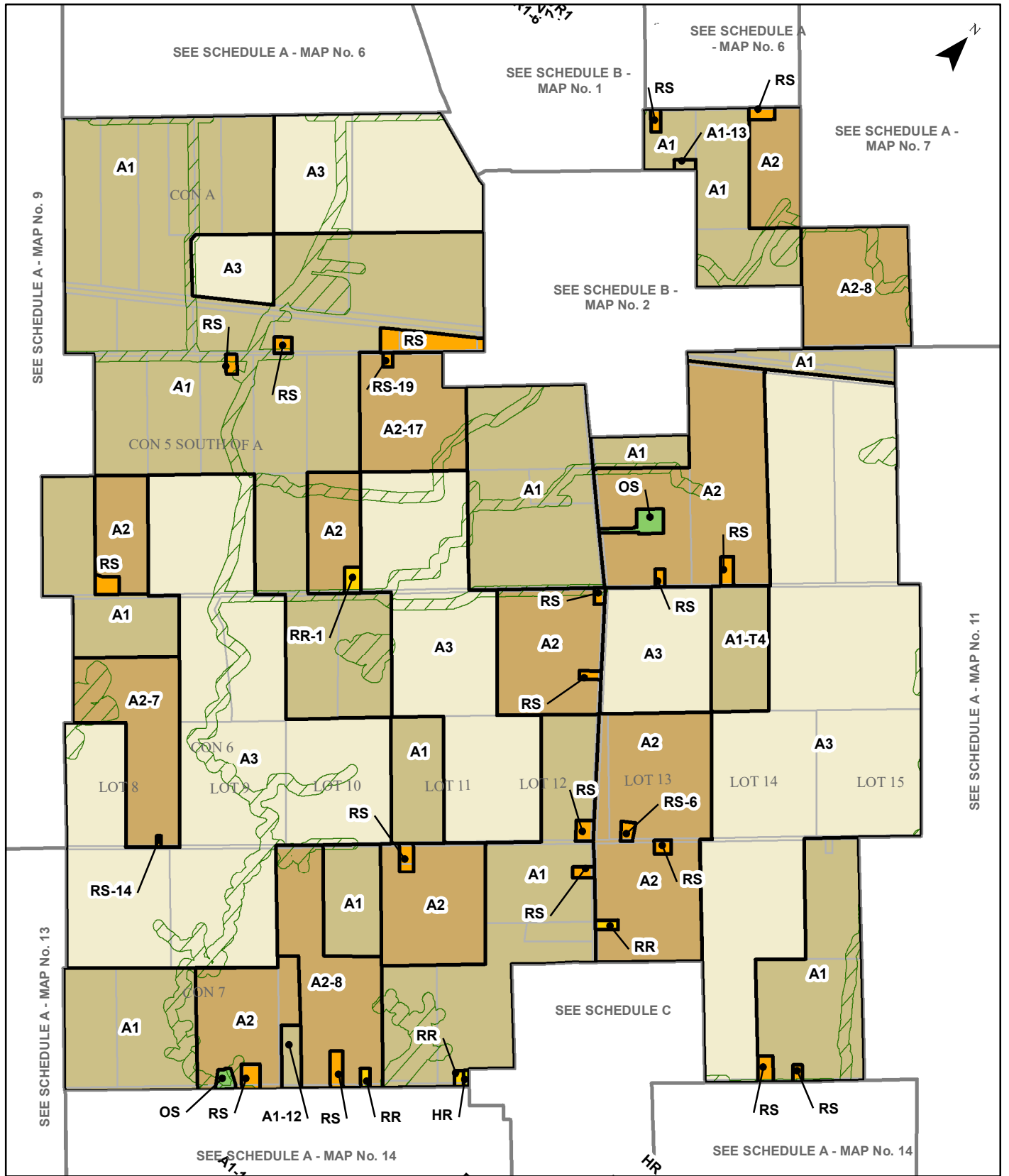

**MUNICIPALITY OF
DUTTON-DUNWICH
SCHEDULE A
MAP No. 10**



LEGEND

- | | | |
|---|---|---|
| <ul style="list-style-type: none"> AGRICULTURE (A1) SPECIAL AGRICULTURE (A2) LARGE LOT AGRICULTURE (A3) VILLAGE RESIDENTIAL ZONE 1 (VR1) VILLAGE RESIDENTIAL ZONE 2 (VR2) HAMLET RESIDENTIAL (HR) RURAL RESIDENTIAL (RR) SPECIAL RURAL RESIDENTIAL (RS) | <ul style="list-style-type: none"> LIMITED SERVICE RESIDENTIAL (LSR) LAKESHORE RECREATION (LR) FARM INDUSTRIAL/COMMERCIAL (M1) RURAL INDUSTRIAL (M2) EXTRACTIVE INDUSTRIAL (M3) VILLAGE INDUSTRIAL (M4) ENVIRONMENTAL PROTECTION (EP) OPEN SPACE (OS) PARKLAND (P) | <ul style="list-style-type: none"> INSTITUTIONAL (I) PUBLIC UTILITY (U) HAMLET COMMERCIAL (HC) HIGHWAY COMMERCIAL (C1) VILLAGE GENERAL COMMERCIAL (VC1) VILLAGE LOCAL COMMERCIAL (VC2) LTVCA REGULATION LIMIT PROVINCIALY SIGNIFICANT WETLAND |
|---|---|---|

SEE SCHEDULE A - MAP No. 7

SEE SCHEDULE A - MAP No. 8



SHACKLETON LINE

CON 5 SOUTH OF A

THOMSON LINE

CON 6

SILVER CLAY LINE

CON 7

TALBOT LINE

WALNUT LINE

SEE SCHEDULE A - MAP No. 10

SEE SCHEDULE A - MAP No. 12

SEE SCHEDULE A - MAP No. 14

SEE SCHEDULE A - MAP No. 15

MUNICIPALITY OF DUTTON-DUNWICH SCHEDULE A MAP No. 11

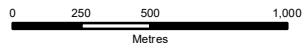

LEGEND

- AGRICULTURE (A1)
- SPECIAL AGRICULTURE (A2)
- LARGE LOT AGRICULTURE (A3)
- VILLAGE RESIDENTIAL ZONE 1 (VR1)
- VILLAGE RESIDENTIAL ZONE 2 (VR2)
- HAMLET RESIDENTIAL (HR)
- RURAL RESIDENTIAL (RR)
- SPECIAL RURAL RESIDENTIAL (RS)
- LIMITED SERVICE RESIDENTIAL (LSR)
- LAKESHORE RECREATION (LR)
- FARM INDUSTRIAL/COMMERCIAL (M1)
- RURAL INDUSTRIAL (M2)
- EXTRACTIVE INDUSTRIAL (M3)
- VILLAGE INDUSTRIAL (M4)
- ENVIRONMENTAL PROTECTION (EP)
- OPEN SPACE (OS)
- PARKLAND (P)
- INSTITUTIONAL (I)
- PUBLIC UTILITY (U)
- HAMLET COMMERCIAL (HC)
- HIGHWAY COMMERCIAL (C1)
- VILLAGE GENERAL COMMERCIAL (VC1)
- VILLAGE LOCAL COMMERCIAL (VC2)
- LTVCA REGULATION LIMIT
- PROVINCIALLY SIGNIFICANT WETLAND

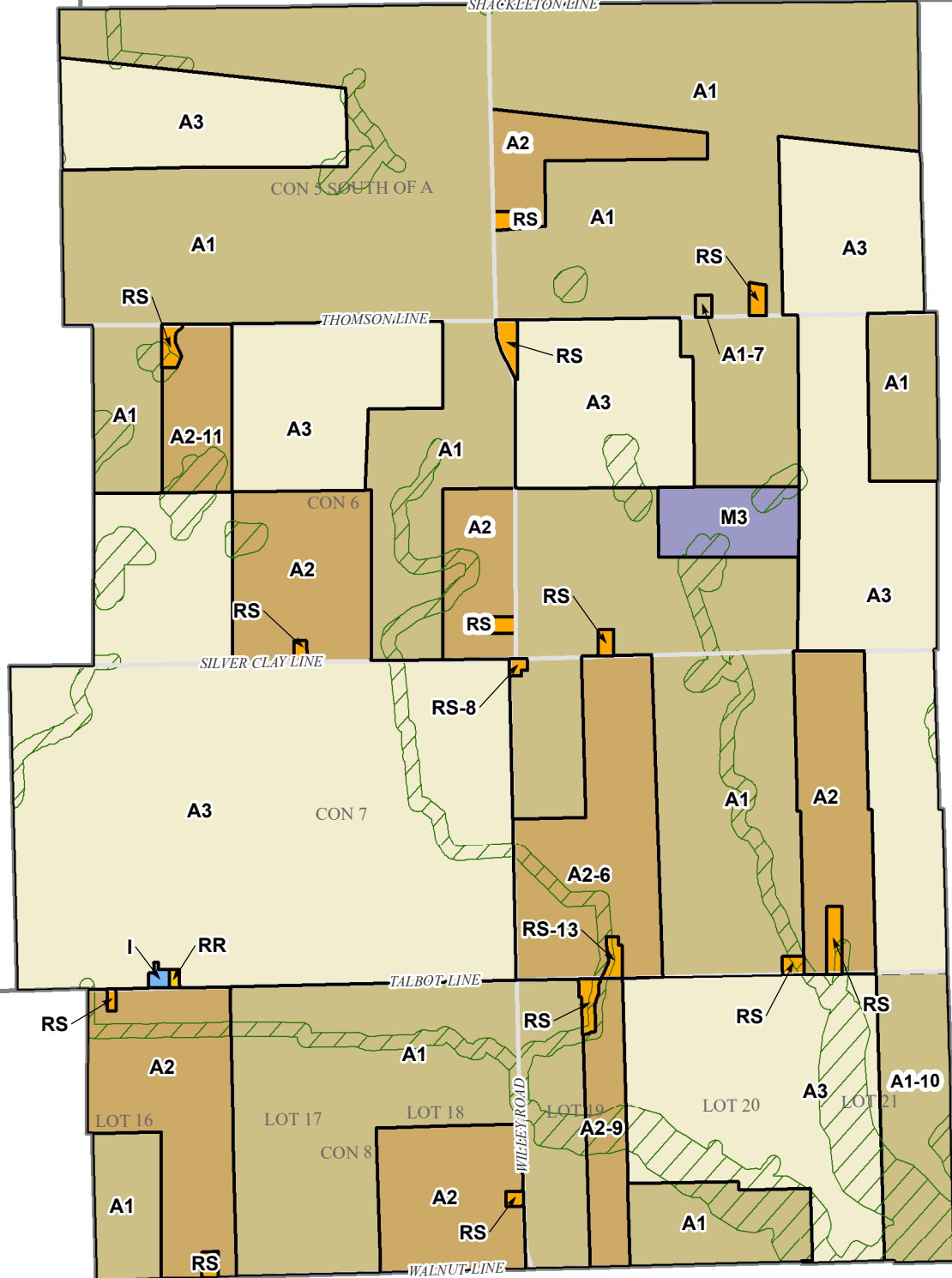

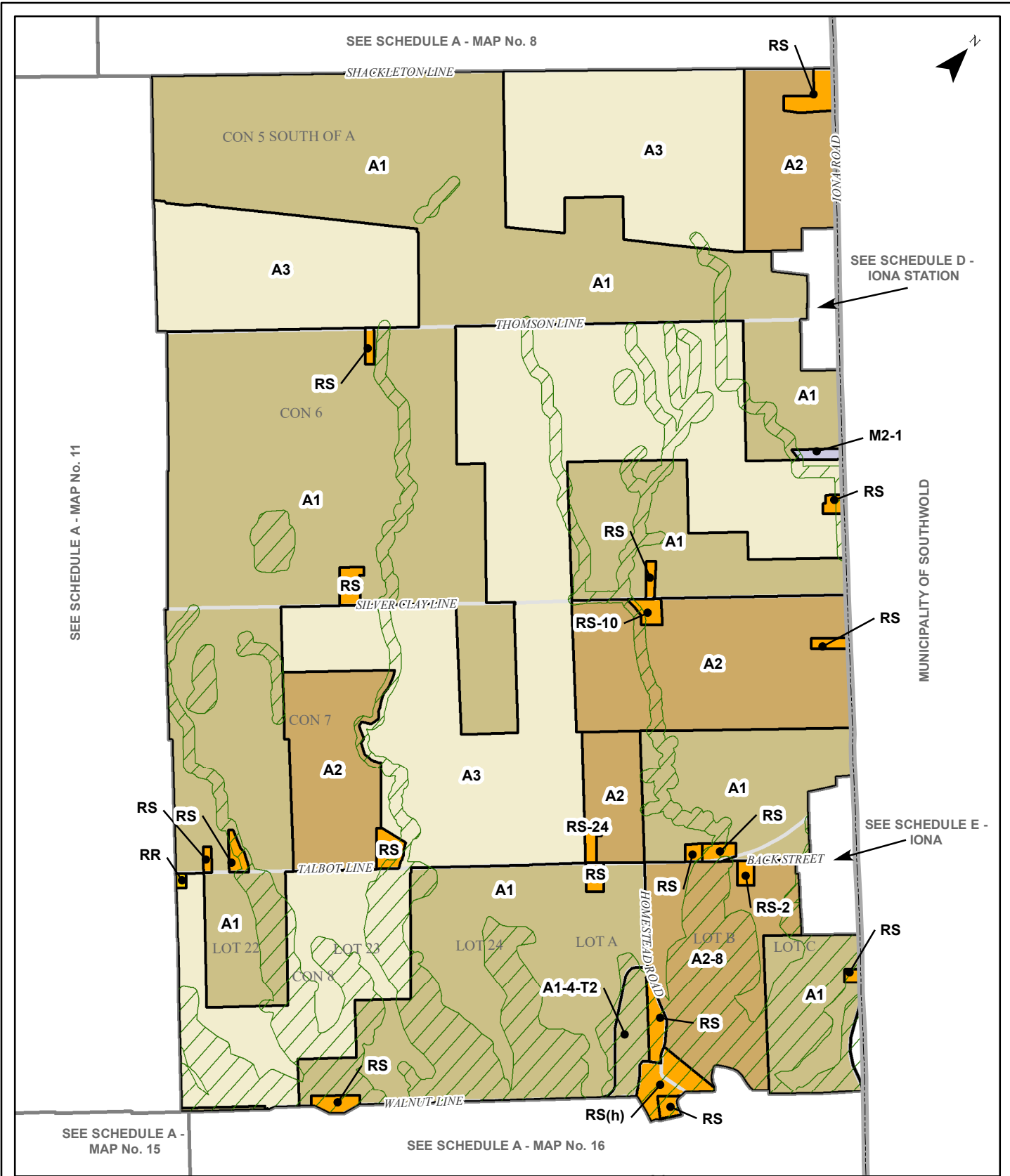

**MUNICIPALITY OF
DUTTON-DUNWICH
SCHEDULE A
MAP No. 12**



LEGEND

- | | | |
|----------------------------------|-----------------------------------|----------------------------------|
| AGRICULTURE (A1) | LIMITED SERVICE RESIDENTIAL (LSR) | INSTITUTIONAL (I) |
| SPECIAL AGRICULTURE (A2) | LAKESHORE RECREATION (LR) | PUBLIC UTILITY (U) |
| LARGE LOT AGRICULTURE (A3) | FARM INDUSTRIAL/COMMERCIAL (M1) | HAMLET COMMERCIAL (HC) |
| VILLAGE RESIDENTIAL ZONE 1 (VR1) | RURAL INDUSTRIAL (M2) | HIGHWAY COMMERCIAL (C1) |
| VILLAGE RESIDENTIAL ZONE 2 (VR2) | EXTRACTIVE INDUSTRIAL (M3) | VILLAGE GENERAL COMMERCIAL (VC1) |
| HAMLET RESIDENTIAL (HR) | VILLAGE INDUSTRIAL (M4) | VILLAGE LOCAL COMMERCIAL (VC2) |
| RURAL RESIDENTIAL (RR) | ENVIRONMENTAL PROTECTION (EP) | LTVCA REGULATION LIMIT |
| SPECIAL RURAL RESIDENTIAL (RS) | OPEN SPACE (OS) | PROVINCIALLY SIGNIFICANT WETLAND |
| | PARKLAND (P) | |

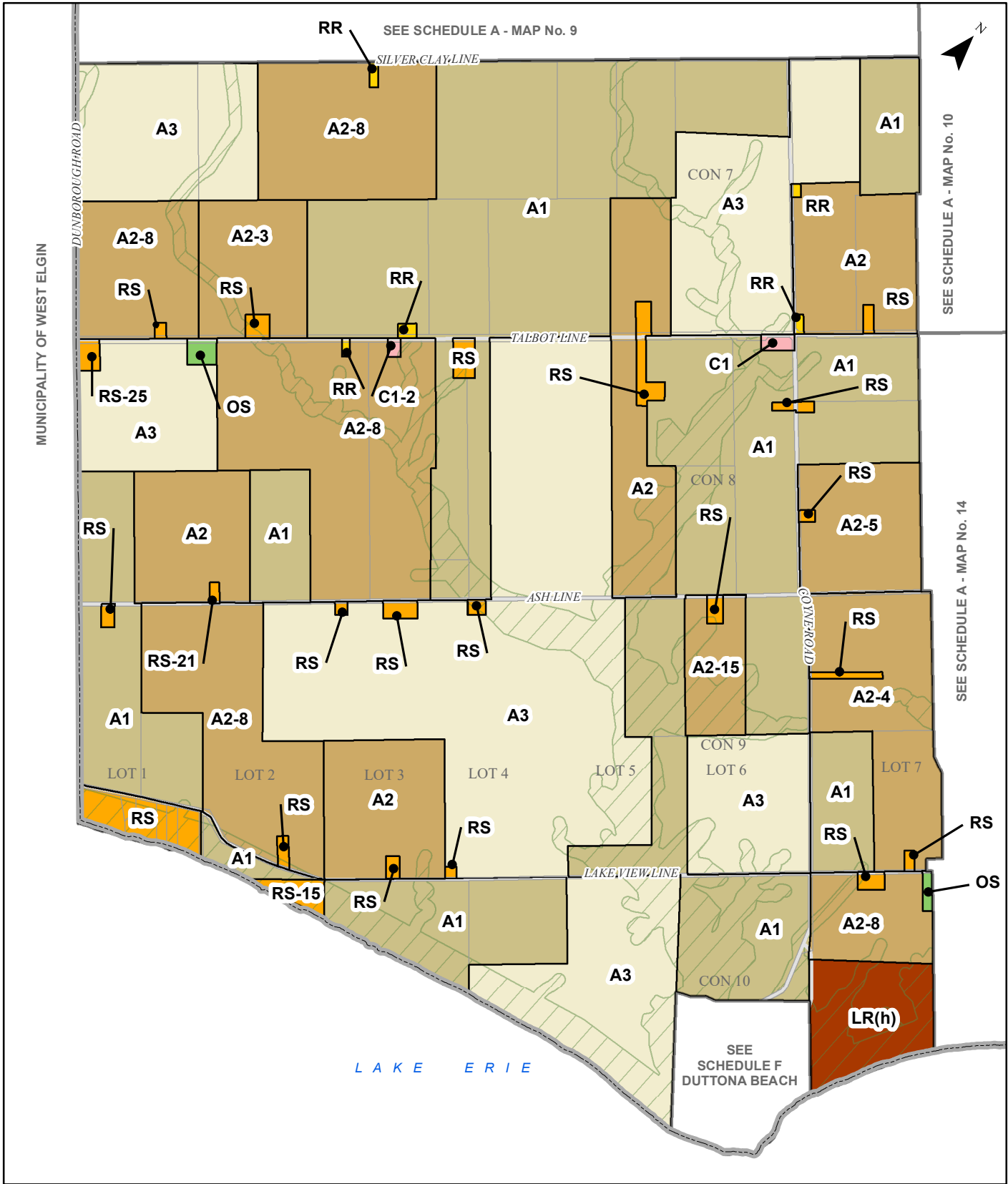

SEE SCHEDULE A - MAP No. 10

SEE SCHEDULE A - MAP No. 14

**MUNICIPALITY OF
DUTTON-DUNWICH
SCHEDULE A
MAP No. 13**

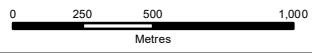

- LEGEND**
- | | | |
|----------------------------------|-----------------------------------|----------------------------------|
| AGRICULTURE (A1) | LIMITED SERVICE RESIDENTIAL (LSR) | INSTITUTIONAL (I) |
| SPECIAL AGRICULTURE (A2) | LAKESHORE RECREATION (LR) | PUBLIC UTILITY (U) |
| LARGE LOT AGRICULTURE (A3) | FARM INDUSTRIAL/COMMERCIAL (M1) | HAMLET COMMERCIAL (HC) |
| VILLAGE RESIDENTIAL ZONE 1 (VR1) | RURAL INDUSTRIAL (M2) | HIGHWAY COMMERCIAL (C1) |
| VILLAGE RESIDENTIAL ZONE 2 (VR2) | EXTRACTIVE INDUSTRIAL (M3) | VILLAGE GENERAL COMMERCIAL (VC1) |
| HAMLET RESIDENTIAL (HR) | VILLAGE INDUSTRIAL (M4) | VILLAGE LOCAL COMMERCIAL (VC2) |
| RURAL RESIDENTIAL (RR) | ENVIRONMENTAL PROTECTION (EP) | LTVCA REGULATION LIMIT |
| SPECIAL RURAL RESIDENTIAL (RS) | OPEN SPACE (OS) | PROVINCIALLY SIGNIFICANT WETLAND |
| | PARKLAND (P) | |

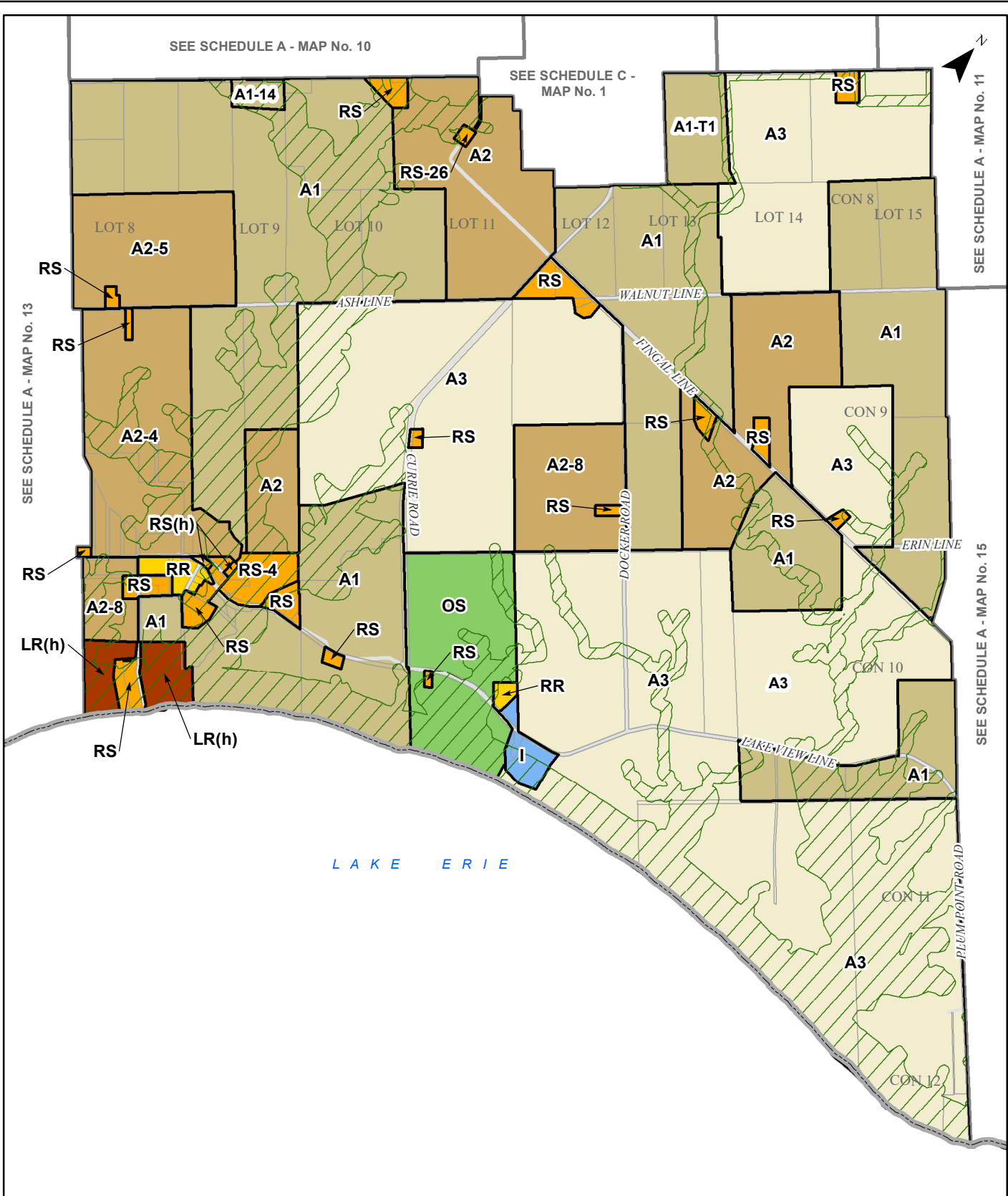

**MUNICIPALITY OF
DUTTON-DUNWICH
SCHEDULE A
MAP No. 14**



LEGEND

- | | | |
|----------------------------------|-----------------------------------|----------------------------------|
| AGRICULTURE (A1) | LIMITED SERVICE RESIDENTIAL (LSR) | INSTITUTIONAL (I) |
| SPECIAL AGRICULTURE (A2) | LAKESHORE RECREATION (LR) | PUBLIC UTILITY (U) |
| LARGE LOT AGRICULTURE (A3) | FARM INDUSTRIAL/COMMERCIAL (M1) | HAMLET COMMERCIAL (HC) |
| VILLAGE RESIDENTIAL ZONE 1 (VR1) | RURAL INDUSTRIAL (M2) | HIGHWAY COMMERCIAL (C1) |
| VILLAGE RESIDENTIAL ZONE 2 (VR2) | EXTRACTIVE INDUSTRIAL (M3) | VILLAGE GENERAL COMMERCIAL (VC1) |
| HAMLET RESIDENTIAL (HR) | VILLAGE INDUSTRIAL (M4) | VILLAGE LOCAL COMMERCIAL (VC2) |
| RURAL RESIDENTIAL (RR) | ENVIRONMENTAL PROTECTION (EP) | LTVCA REGULATION LIMIT |
| SPECIAL RURAL RESIDENTIAL (RS) | OPEN SPACE (OS) | PROVINCIALY SIGNIFICANT WETLAND |
| | PARKLAND (P) | |

SEE SCHEDULE A - MAP No. 11



SEE SCHEDULE A - MAP No. 14

SEE SCHEDULE A - MAP No. 16

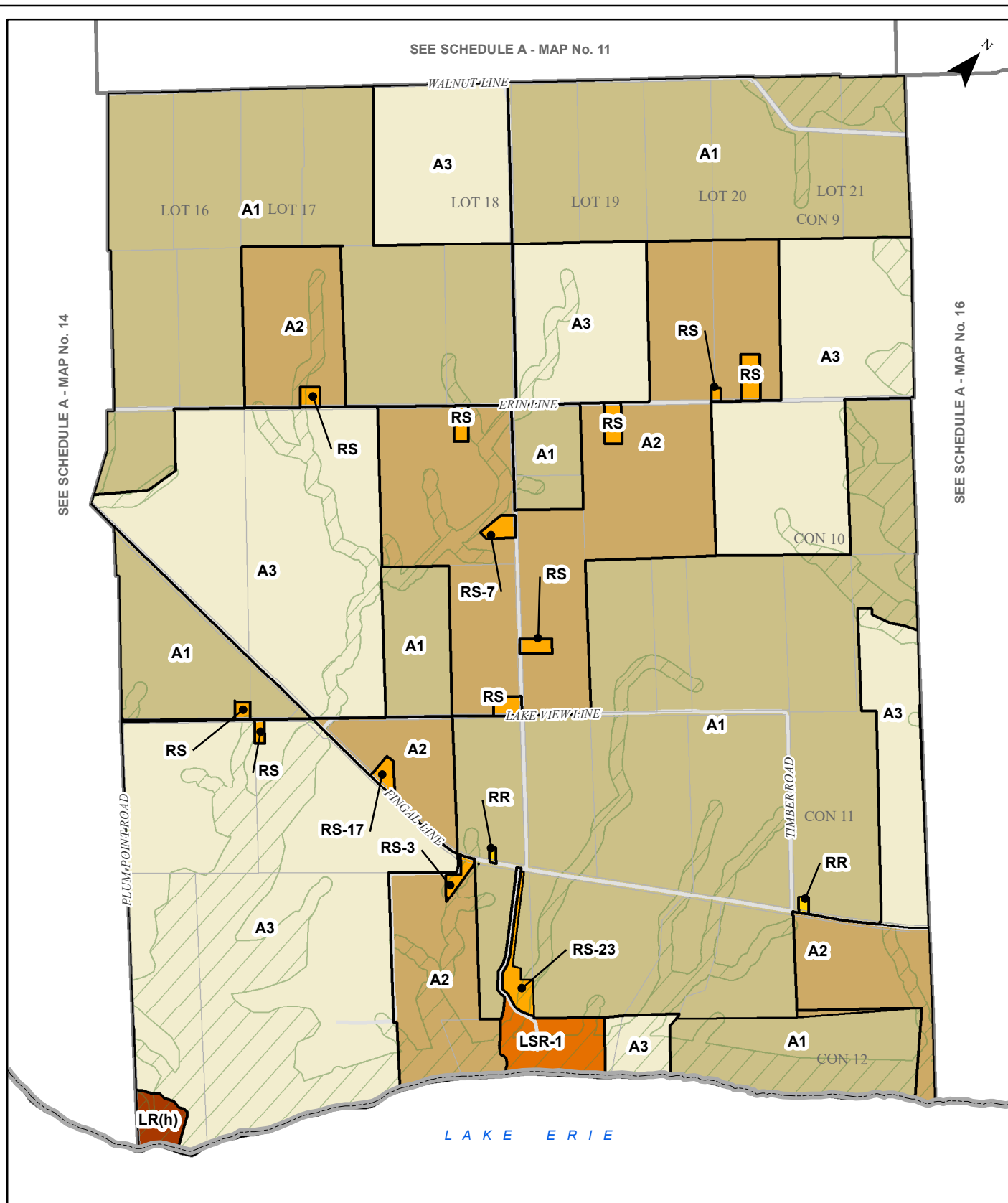

**MUNICIPALITY OF
DUTTON-DUNWICH
SCHEDULE A
MAP No. 15**



LEGEND

- | | | |
|---|---|---|
| <ul style="list-style-type: none"> AGRICULTURE (A1) SPECIAL AGRICULTURE (A2) LARGE LOT AGRICULTURE (A3) VILLAGE RESIDENTIAL ZONE 1 (VR1) VILLAGE RESIDENTIAL ZONE 2 (VR2) HAMLET RESIDENTIAL (HR) RURAL RESIDENTIAL (RR) SPECIAL RURAL RESIDENTIAL (RS) | <ul style="list-style-type: none"> LIMITED SERVICE RESIDENTIAL (LSR) LAKESHORE RECREATION (LR) FARM INDUSTRIAL/COMMERCIAL (M1) RURAL INDUSTRIAL (M2) EXTRACTIVE INDUSTRIAL (M3) VILLAGE INDUSTRIAL (M4) ENVIRONMENTAL PROTECTION (EP) OPEN SPACE (OS) PARKLAND (P) | <ul style="list-style-type: none"> INSTITUTIONAL (I) PUBLIC UTILITY (U) HAMLET COMMERCIAL (HC) HIGHWAY COMMERCIAL (C1) VILLAGE GENERAL COMMERCIAL (VC1) VILLAGE LOCAL COMMERCIAL (VC2) LTVCA REGULATION LIMIT PROVINCIAALLY SIGNIFICANT WETLAND |
|---|---|---|

SEE SCHEDULE A - MAP No. 11

SEE SCHEDULE A - MAP No. 12

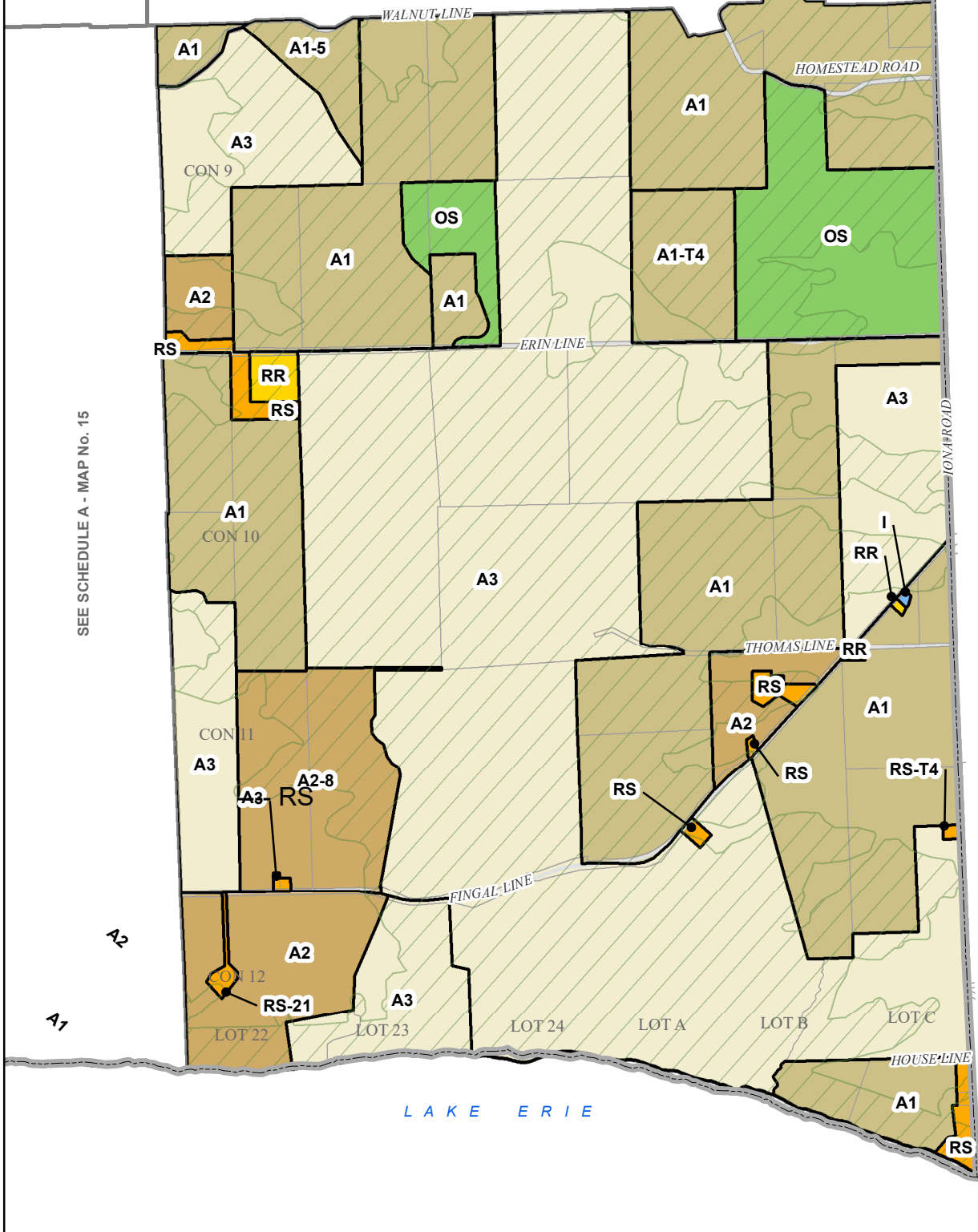

**MUNICIPALITY OF
DUTTON-DUNWICH
SCHEDULE A
MAP No. 16**

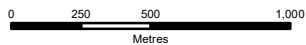

LEGEND

- | | | |
|----------------------------------|-----------------------------------|----------------------------------|
| AGRICULTURE (A1) | LIMITED SERVICE RESIDENTIAL (LSR) | INSTITUTIONAL (I) |
| SPECIAL AGRICULTURE (A2) | LAKESHORE RECREATION (LR) | PUBLIC UTILITY (U) |
| LARGE LOT AGRICULTURE (A3) | FARM INDUSTRIAL/COMMERCIAL (M1) | HAMLET COMMERCIAL (HC) |
| VILLAGE RESIDENTIAL ZONE 1 (VR1) | RURAL INDUSTRIAL (M2) | HIGHWAY COMMERCIAL (C1) |
| VILLAGE RESIDENTIAL ZONE 2 (VR2) | EXTRACTIVE INDUSTRIAL (M3) | VILLAGE GENERAL COMMERCIAL (VC1) |
| HAMLET RESIDENTIAL (HR) | VILLAGE INDUSTRIAL (M4) | VILLAGE LOCAL COMMERCIAL (VC2) |
| RURAL RESIDENTIAL (RR) | ENVIRONMENTAL PROTECTION (EP) | LTVCA REGULATORY LIMIT |
| SPECIAL RURAL RESIDENTIAL (RS) | OPEN SPACE (OS) | PROVINCIALY SIGNIFICANT WETLAND |
| | PARKLAND (P) | |



SEE SCHEDULE A - MAP No. 6

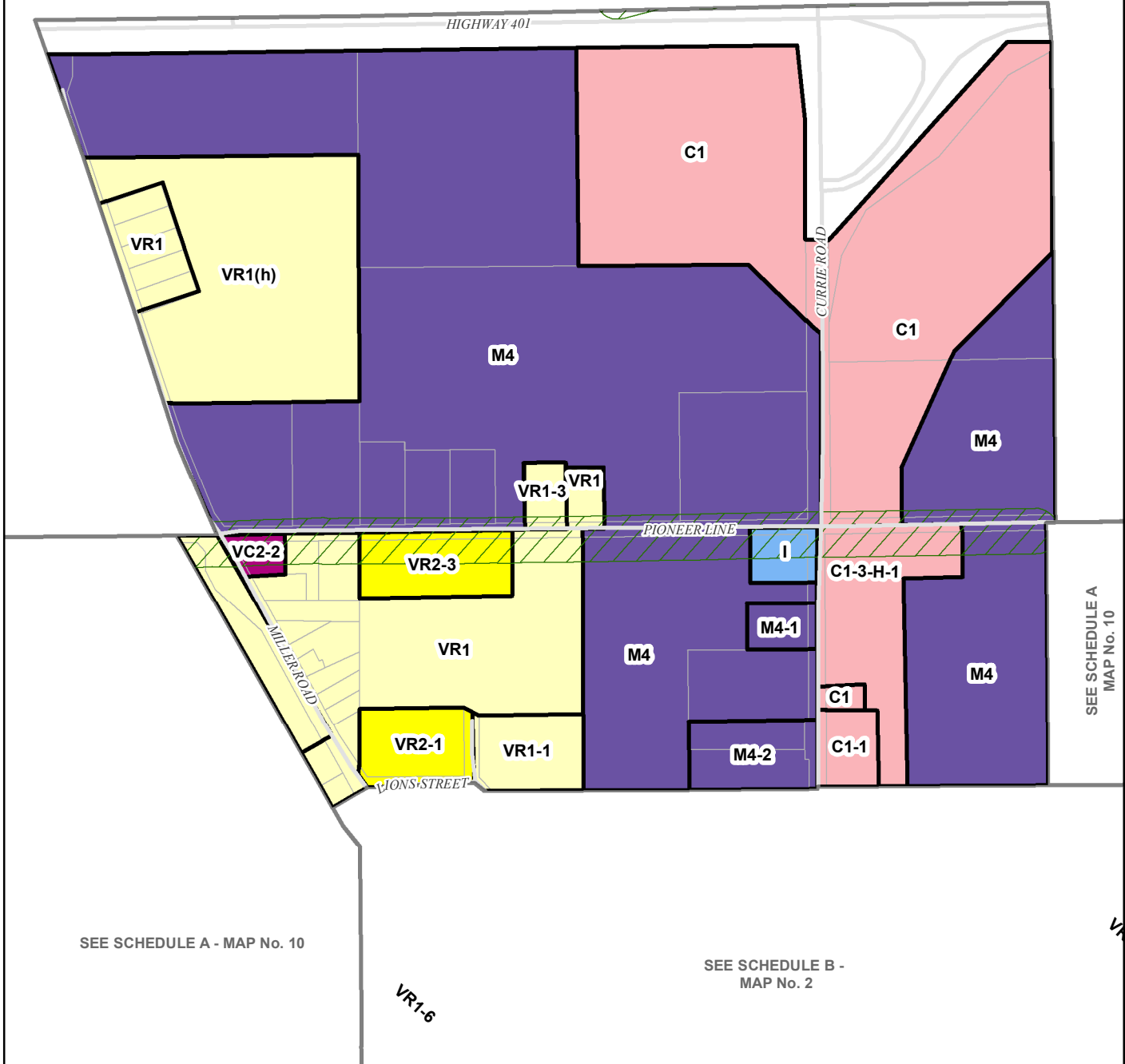

SEE SCHEDULE A - MAP No. 10

SEE SCHEDULE A
MAP No. 10

SEE SCHEDULE B -
MAP No. 2

**MUNICIPALITY OF
DUTTON-DUNWICH
SCHEDULE B - DUTTON
MAP No. 1**

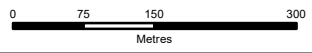

LEGEND

AGRICULTURE (A1)	LIMITED SERVICE RESIDENTIAL (LSR)	INSTITUTIONAL (I)
SPECIAL AGRICULTURE (A2)	LAKESHORE RECREATION (LR)	PUBLIC UTILITY (U)
LARGE LOT AGRICULTURE (A3)	FARM INDUSTRIAL/COMMERCIAL (M1)	HAMLET COMMERCIAL (HC)
VILLAGE RESIDENTIAL ZONE 1 (VR1)	RURAL INDUSTRIAL (M2)	HIGHWAY COMMERCIAL (C1)
VILLAGE RESIDENTIAL ZONE 2 (VR2)	EXTRACTIVE INDUSTRIAL (M3)	VILLAGE GENERAL COMMERCIAL (VC1)
HAMLET RESIDENTIAL (HR)	VILLAGE INDUSTRIAL (M4)	VILLAGE LOCAL COMMERCIAL (VC2)
RURAL RESIDENTIAL (RR)	ENVIRONMENTAL PROTECTION (EP)	LTVCA REGULATION LIMIT
SPECIAL RURAL RESIDENTIAL (RS)	OPEN SPACE (OS)	PROVINCIALY SIGNIFICANT WETLAND
	PARKLAND (P)	

SEE SCHEDULE A - MAP No. 6

SEE SCHEDULE B - MAP No. 1

SEE SCHEDULE A - MAP No. 7

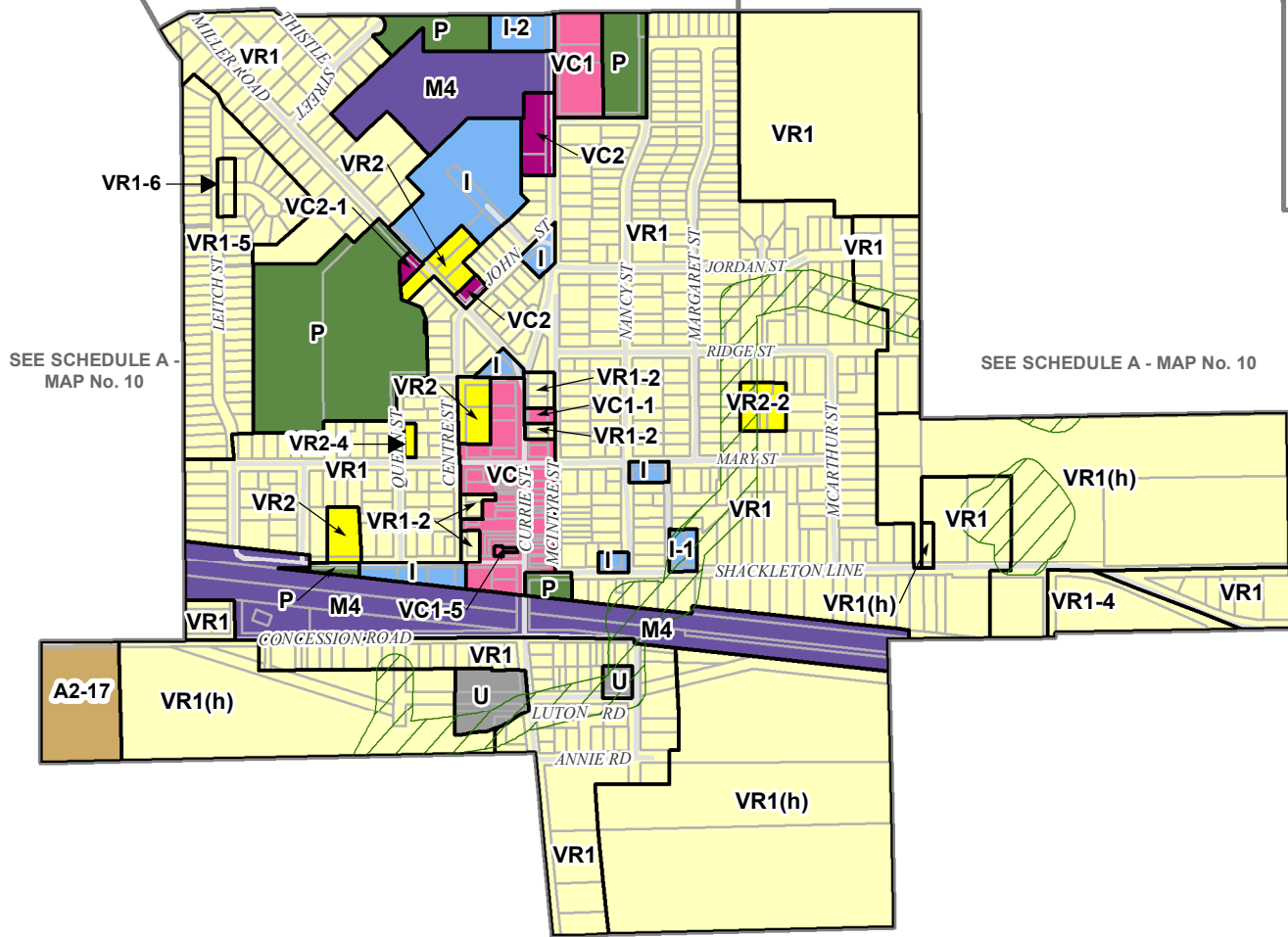

SEE SCHEDULE A - MAP No. 10

SEE SCHEDULE A - MAP No. 10

SEE SCHEDULE A - MAP No. 10

**MUNICIPALITY OF
DUTTON-DUNWICH
SCHEDULE B - DUTTON
MAP No. 2**

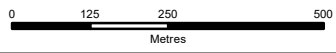

LEGEND

AGRICULTURE (A1)	LIMITED SERVICE RESIDENTIAL (LSR)	INSTITUTIONAL (I)
SPECIAL AGRICULTURE (A2)	LAKESHORE RECREATION (LR)	PUBLIC UTILITY (U)
LARGE LOT AGRICULTURE (A3)	FARM INDUSTRIAL/COMMERCIAL (M1)	HAMLET COMMERCIAL (HC)
VILLAGE RESIDENTIAL ZONE 1 (VR1)	RURAL INDUSTRIAL (M2)	HIGHWAY COMMERCIAL (C1)
VILLAGE RESIDENTIAL ZONE 2 (VR2)	EXTRACTIVE INDUSTRIAL (M3)	VILLAGE GENERAL COMMERCIAL (VC1)
HAMLET RESIDENTIAL (HR)	VILLAGE INDUSTRIAL (M4)	VILLAGE LOCAL COMMERCIAL (VC2)
RURAL RESIDENTIAL (RR)	ENVIRONMENTAL PROTECTION (EP)	LTVCA REGULATION LIMIT
SPECIAL RURAL RESIDENTIAL (RS)	OPEN SPACE (OS)	PROVINCIALY SIGNIFICANT WETLAND
	PARKLAND (P)	



SEE SCHEDULE A - MAP No. 10

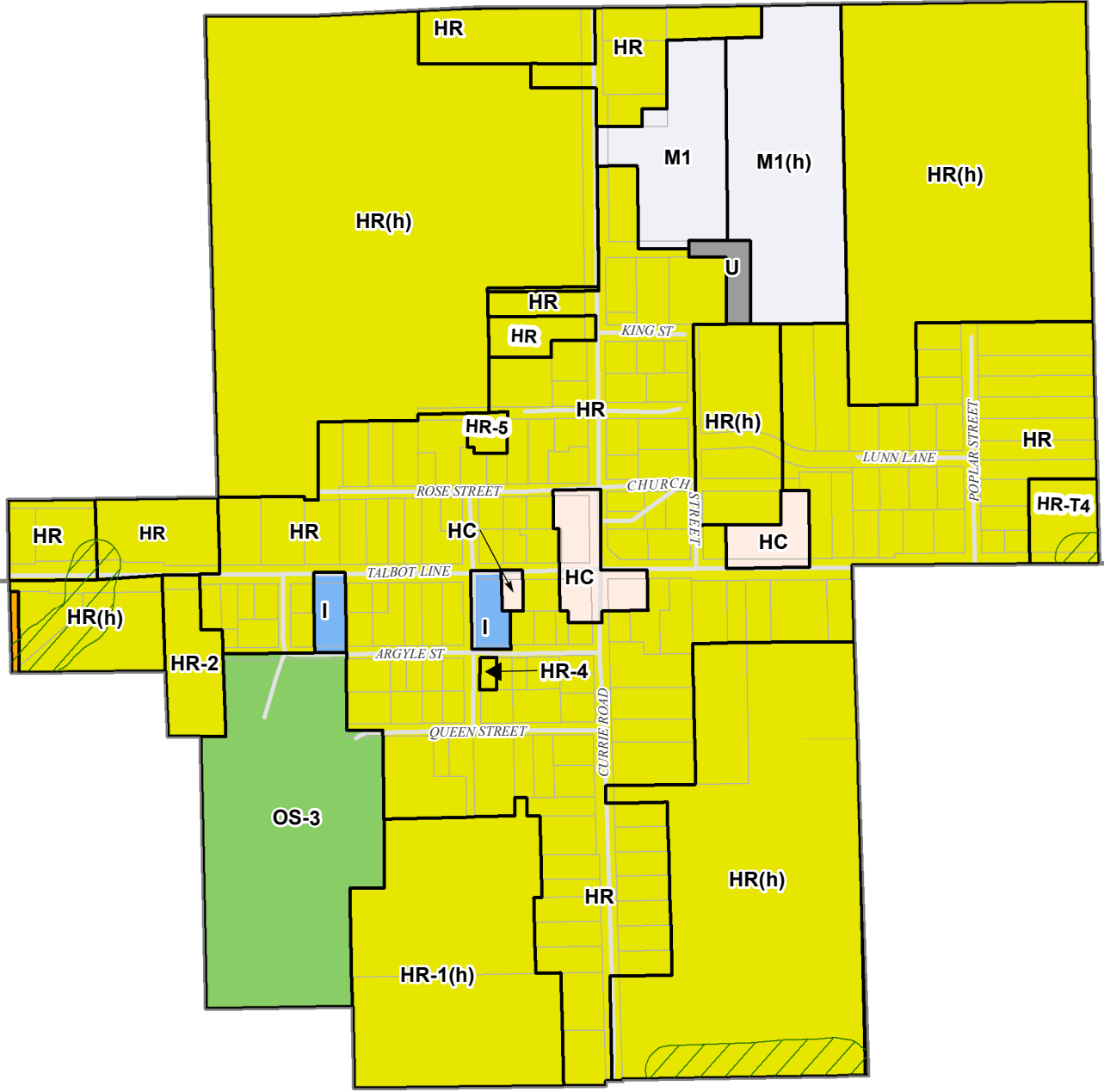

SEE SCHEDULE A - MAP No. 14

**MUNICIPALITY OF
DUTTON-DUNWICH
SCHEDULE C - WALLACETOWN
MAP No. 1**

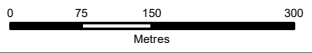

LEGEND			
	AGRICULTURE (A1)		INSTITUTIONAL (I)
	SPECIAL AGRICULTURE (A2)		PUBLIC UTILITY (U)
	LARGE LOT AGRICULTURE (A3)		HAMLET COMMERCIAL (HC)
	VILLAGE RESIDENTIAL ZONE 1 (VR1)		HIGHWAY COMMERCIAL (C1)
	VILLAGE RESIDENTIAL ZONE 2 (VR2)		VILLAGE GENERAL COMMERCIAL (VC1)
	HAMLET RESIDENTIAL (HR)		VILLAGE LOCAL COMMERCIAL (VC2)
	RURAL RESIDENTIAL (RR)		LTVCA REGULATION LIMIT
	SPECIAL RURAL RESIDENTIAL (RS)		PROVINCIALY SIGNIFICANT WETLAND

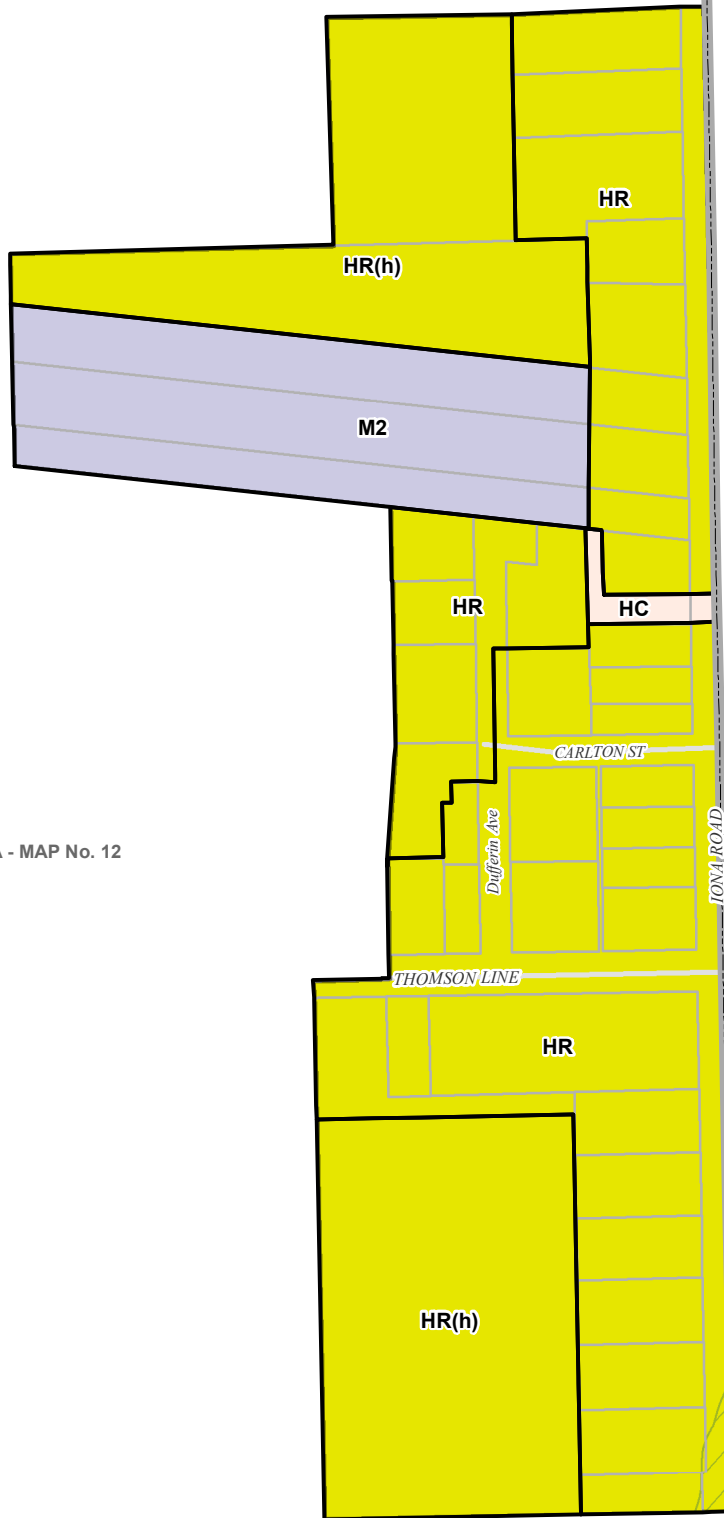

SEE SCHEDULE A - MAP No. 12

Municipality of Southwold

**MUNICIPALITY OF
DUTTON-DUNWICH
SCHEDULE D - IONA STATION
MAP No. 1**

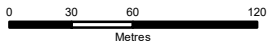

LEGEND

- | | | |
|----------------------------------|-----------------------------------|----------------------------------|
| AGRICULTURE (A1) | LIMITED SERVICE RESIDENTIAL (LSR) | INSTITUTIONAL (I) |
| SPECIAL AGRICULTURE (A2) | LAKESHORE RECREATION (LR) | PUBLIC UTILITY (U) |
| LARGE LOT AGRICULTURE (A3) | FARM INDUSTRIAL/COMMERCIAL (M1) | HAMLET COMMERCIAL (HC) |
| VILLAGE RESIDENTIAL ZONE 1 (VR1) | RURAL INDUSTRIAL (M2) | HIGHWAY COMMERCIAL (C1) |
| VILLAGE RESIDENTIAL ZONE 2 (VR2) | EXTRACTIVE INDUSTRIAL (M3) | VILLAGE GENERAL COMMERCIAL (VC1) |
| HAMLET RESIDENTIAL (HR) | VILLAGE INDUSTRIAL (M4) | VILLAGE LOCAL COMMERCIAL (VC2) |
| RURAL RESIDENTIAL (RR) | ENVIRONMENTAL PROTECTION (EP) | LTVCA REGULATION LIMIT |
| SPECIAL RURAL RESIDENTIAL (RS) | OPEN SPACE (OS) | PROVINCIALLY SIGNIFICANT WETLAND |
| | PARKLAND (P) | |



SEE SCHEDULE A - MAP No. 12

Municipality of Southwold

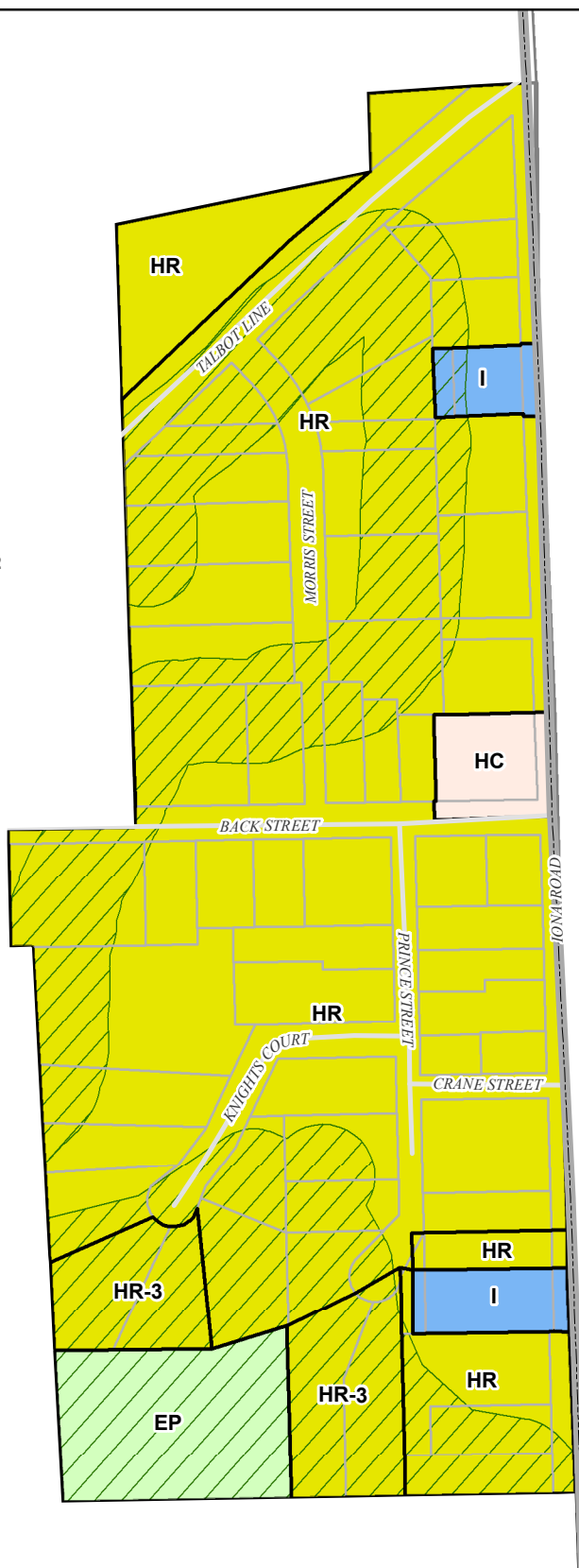

**MUNICIPALITY OF
DUTTON-DUNWICH
SCHEDULE E - IONA
MAP No. 1**

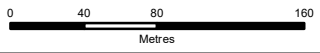

LEGEND	
AGRICULTURE (A1)	LIMITED SERVICE RESIDENTIAL (LSR)
SPECIAL AGRICULTURE (A2)	LAKESHORE RECREATION (LR)
LARGE LOT AGRICULTURE (A3)	FARM INDUSTRIAL/COMMERCIAL (M1)
VILLAGE RESIDENTIAL ZONE 1 (VR1)	RURAL INDUSTRIAL (M2)
VILLAGE RESIDENTIAL ZONE 2 (VR2)	EXTRACTIVE INDUSTRIAL (M3)
HAMLET RESIDENTIAL (HR)	VILLAGE INDUSTRIAL (M4)
RURAL RESIDENTIAL (RR)	ENVIRONMENTAL PROTECTION (EP)
SPECIAL RURAL RESIDENTIAL (RS)	OPEN SPACE (OS)
	PARKLAND (P)
	INSTITUTIONAL (I)
	PUBLIC UTILITY (U)
	HAMLET COMMERCIAL (HC)
	HIGHWAY COMMERCIAL (C1)
	VILLAGE GENERAL COMMERCIAL (VC1)
	VILLAGE LOCAL COMMERCIAL (VC2)
	LTVCA REGULATION LIMIT
	PROVINCIALY SIGNIFICANT WETLAND

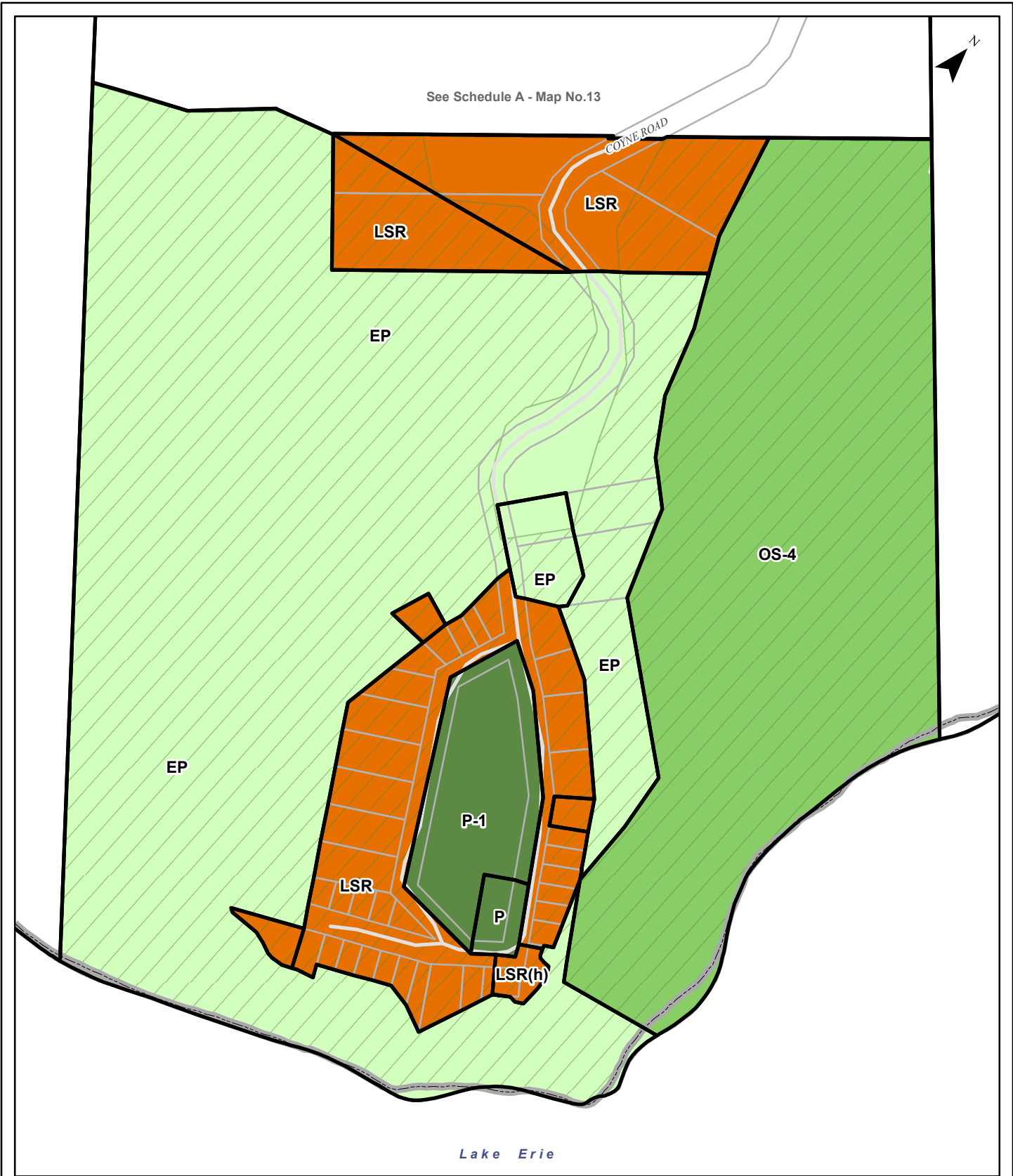

**MUNICIPALITY OF
DUTTON-DUNWICH
SCHEDULE F - DUTTONA BEACH
MAP No. 1**

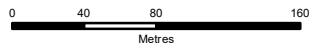

LEGEND

- | | | |
|----------------------------------|-----------------------------------|----------------------------------|
| AGRICULTURE (A1) | LIMITED SERVICE RESIDENTIAL (LSR) | INSTITUTIONAL (I) |
| SPECIAL AGRICULTURE (A2) | LAKESHORE RECREATION (LR) | PUBLIC UTILITY (U) |
| LARGE LOT AGRICULTURE (A3) | FARM INDUSTRIAL/COMMERCIAL (M1) | HAMLET COMMERCIAL (HC) |
| VILLAGE RESIDENTIAL ZONE 1 (VR1) | RURAL INDUSTRIAL (M2) | HIGHWAY COMMERCIAL (C1) |
| VILLAGE RESIDENTIAL ZONE 2 (VR2) | EXTRACTIVE INDUSTRIAL (M3) | VILLAGE GENERAL COMMERCIAL (VC1) |
| HAMLET RESIDENTIAL (HR) | VILLAGE INDUSTRIAL (M4) | VILLAGE LOCAL COMMERCIAL (VC2) |
| RURAL RESIDENTIAL (RR) | ENVIRONMENTAL PROTECTION (EP) | LTVCA REGULATION LIMIT |
| SPECIAL RURAL RESIDENTIAL (RS) | OPEN SPACE (OS) | PROVINCIAL SIGNIFICANT WETLAND |
| | PARKLAND (P) | |
| | PARKLAND (P-1) | |
| | LAKESHORE RECREATION (LSR(h)) | |